

**THE 32<sup>nd</sup> ANNUAL SHEEPSHEARING FESTIVAL**

Saturday, April 27, 2019

10 am - 5 pm



photo by Eric Workman | TMP Images

**THANK YOU TO OUR SPONSORS!**



**THANK YOU TO OUR IN-KIND DONORS!**

- Circus Smirkus
- Education Development Center
- Jewish Community Day School
- Waltham Garden Club

52 Gore Street, Waltham, MA 02453 • [www.goreplace.org](http://www.goreplace.org)  
 (781) 894-2798

**SCHEDULE OF EVENTS**

10 am - 5 pm

<b>Performance Tent</b>	#4 on map
Lindsay and Her Puppet Pals <i>approx. 30 minutes</i>	10:30, 11:30, 2:30 & 4:00
Circus Smirkus <i>approx. 30 minutes</i>	12:30, 1:30 & 3:30
<b>Maypole Dance</b>	
Outside Music Tent <i>approx. 40 minutes</i>	#1 on map 1:00
<b>Music Tent</b>	#1 on map
<i>approx. 40 minutes each show</i>	
Merrimack Valley Bluegrass	12:00, 2:00 & 4:00
Moody Street String Band	1:00 & 3:00
<b>Herding Dog Demonstrations</b>	#6 on map
<i>approx. 45 minutes</i>	11:00, 12:30, 2:00 & 3:30
<b>Mansion Tours - 1st floor only</b>	#3 on map
\$3 per person <i>approx. 15 minute guided tour</i>	11:00 to 4:00



Top of the Maypole at the Sheepshearing Festival

Photo by Susan Flaherty @sufaherty  
 Manager of @IGERSMASS

Share your photos with us! #goreplace #sheepfest32

**Colonel Bailey's 2nd MA Regiment**

Music to start the day	10:00
Children's Drill	10:30
Parade around the grounds	11:00
Firing Procedure Demo and Music	11:30
Children's Drill	11:45
"Nooning"	12:00
Rounder's Game	1:00
Parade around the grounds	2:00
Firing Procedure Demo and Music	2:30
Children's Drill	2:45
Parade around the grounds	3:30
Firing Procedure Demo and Music	4:00
Children's Drill	4:15

**All Day Activities:**

Crafts Fair & Historic Crafters	
Electric Shearing	#2 on map
Traditional Blade Shearing	#9 on map
Morris Dancing	various locations
Fiber Arts	#8 on map
Fiber Arts Activities	#8 on map
Wagon Rides (\$5 per family)	#5 on map
Lacemaking & Quilting Demos	#3 on map
1812 Marine Guard	near #2 on map
Gore Place Kids' Activities	near #4 on map

(Note: Schedule subject to change.)

**Upcoming Programs at Gore Place:**

• Guided tours of the 1806 Mansion	every Monday-Saturday
• Spring Plant Sale	May 17, 18, 19
• <i>Be Inspired: A Celebration of Floral Design</i>	June 12, 13, 14
"The Garden Tourist" Lecture by Jana Milbocker	June 13
Floral Design Demonstrations by A Natural Arrangement	June 14

**Host your next event with us!**

- Weddings, birthdays, corporate retreats and more.

Learn more at [goreplace.org](http://goreplace.org)

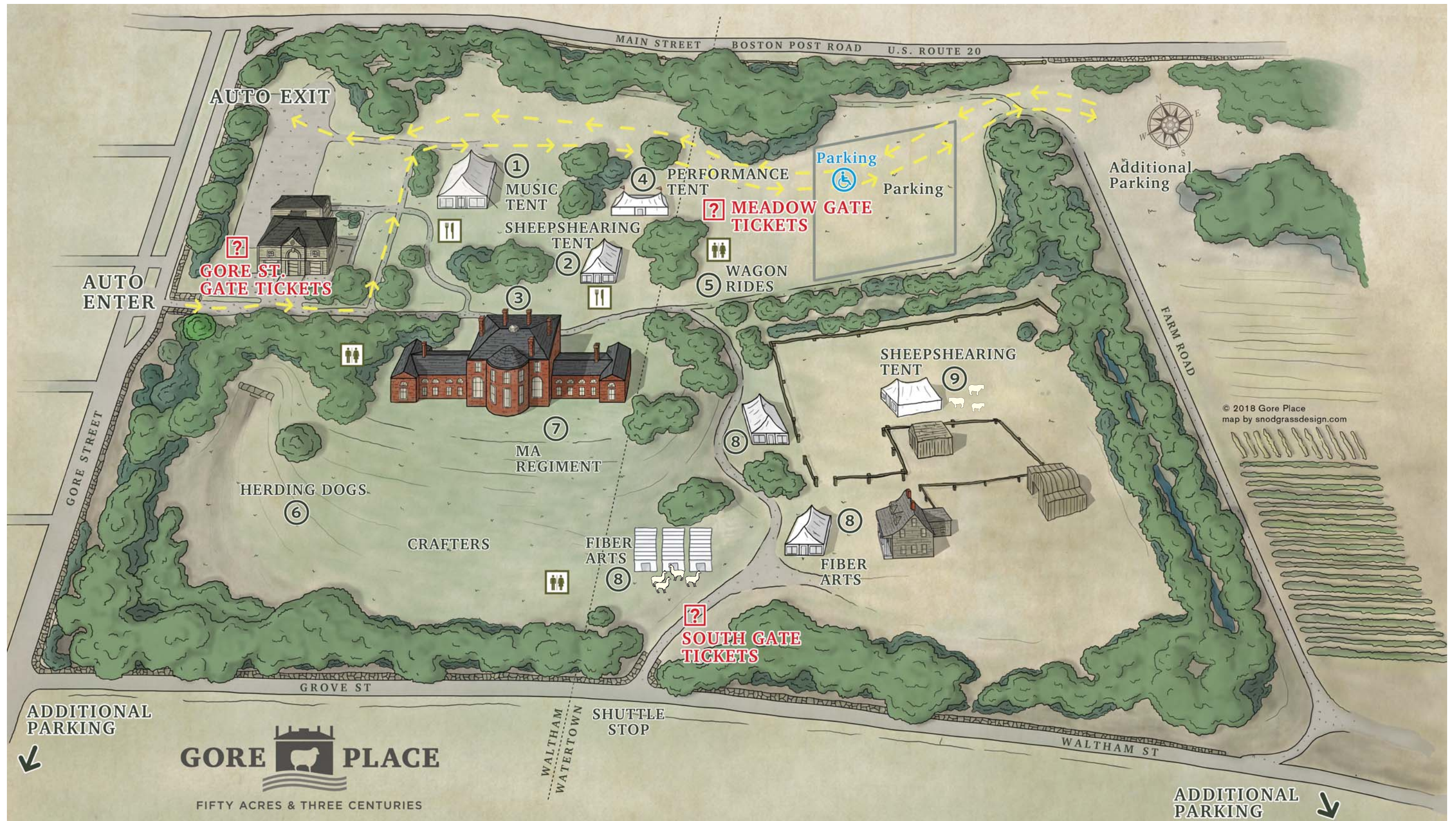

**Map Legend**

- |                               |                    |                      |                         |                      |
|-------------------------------|--------------------|----------------------|-------------------------|----------------------|
| ① Music Tent                  | ④ Performance Tent | ⑦ MA Regiment        | 🚻 Restrooms             | ♿ Accessible Parking |
| ② Sheepshearing Tent          | ⑤ Wagon Rides      | ⑧ Fiber Arts         | 🍴 Food                  |                      |
| ③ Mansion Tours & Information | ⑥ Herding Dogs     | ⑨ Sheepshearing Tent | ❓ Information & Tickets |                      |